

SUBDIVISIONAL SALE OF 2,300 ACRES

KNOWN AS

Moffatt's Leigh Estate

being that portion of the above property nearest the township of Inverleigh, and including the whole of the river flats which have a frontage of about Two and a half miles to the Leigh River.

TO BE OFFERED IN 18 FARMS, RANGING FROM 35 ACRES TO 260 ACRES.

TERMS exceptionally liberal, one-third cash, balance in five years. Interest Four and a half per cent. per annum.
Plans obtainable from the Agents.

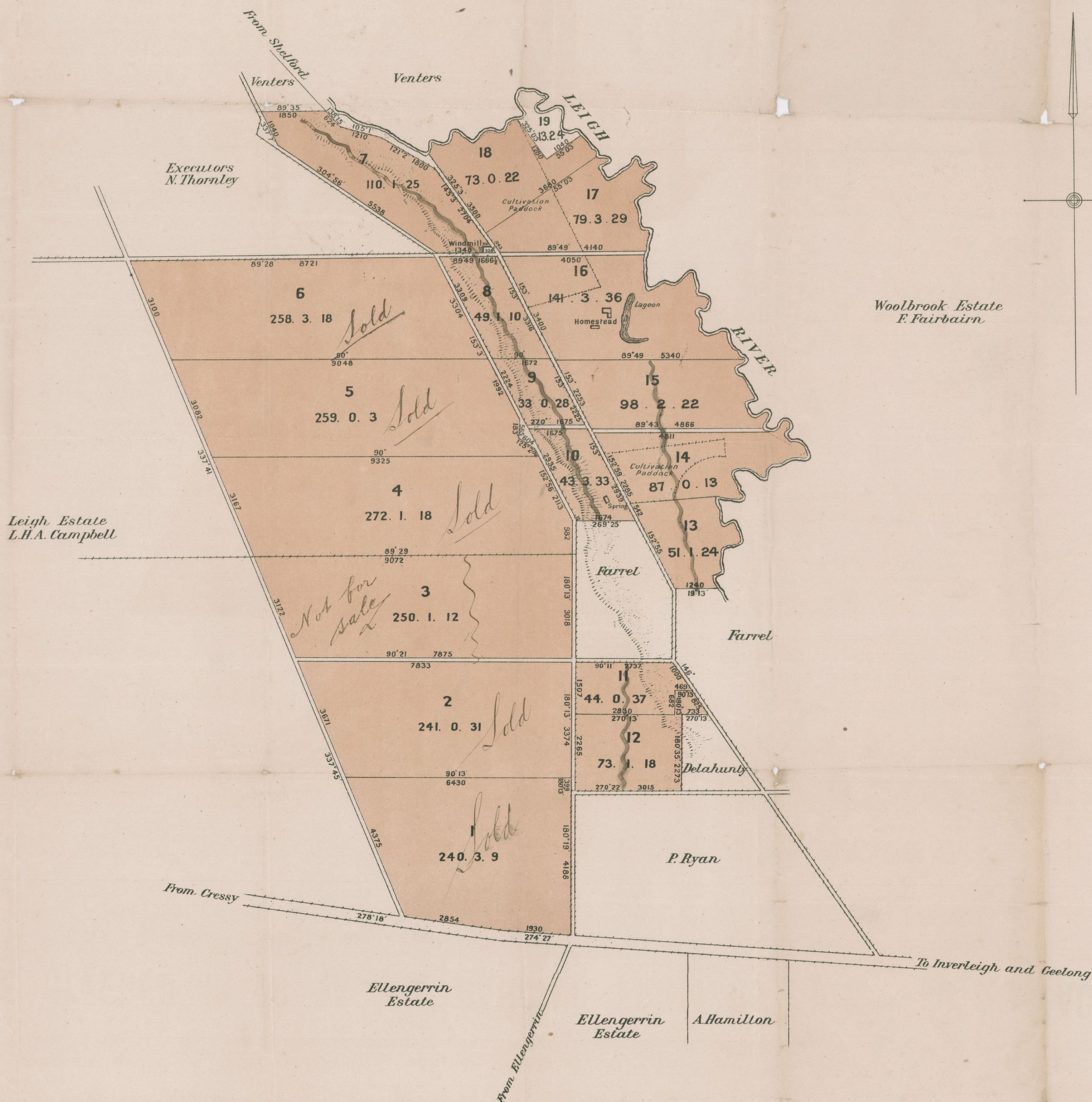

To be offered by Public Auction under instructions from Mrs. L. H. A. Campbell, at the WOOL EXCHANGE, VICTORIA HOTEL, GEELONG, on
THURSDAY, 19TH NOVEMBER, 1903,

commencing at Two o'clock p.m. Possession of Lots 14, 17, and 18 given on 31st January, 1904, of Lot 16 on 1st March, 1904, and of the remaining 14 Lots on 23rd December, 1903.

**HOWE & CAMPBELL, Geelong; NEIL CAMPBELL, Geelong;
HOWE, CAMPBELL & VALENTINE, Collins Street, Melbourne;**

AGENTS IN CONJUNCTION.