

# Saturday, August 30th, 1924

At 2.30 p.m., at SALE YARDS, WERRIBEE.

## AUCTION SALE.

# Splendid COUNTRY HOME

75 Acres Lucerne Land on Werribee River

At **WERRIBEE**

21 Miles  
from  
Melbourne.

**T. H. LAIDLAW & CO. and  
THOS. ROADKNIGHT & CO.**

In conjunction, have been instructed by S. W. Blackler, Esq., to Offer STURNDALÉ PROPERTY by Public Auction, as a whole or in Lots as shown.

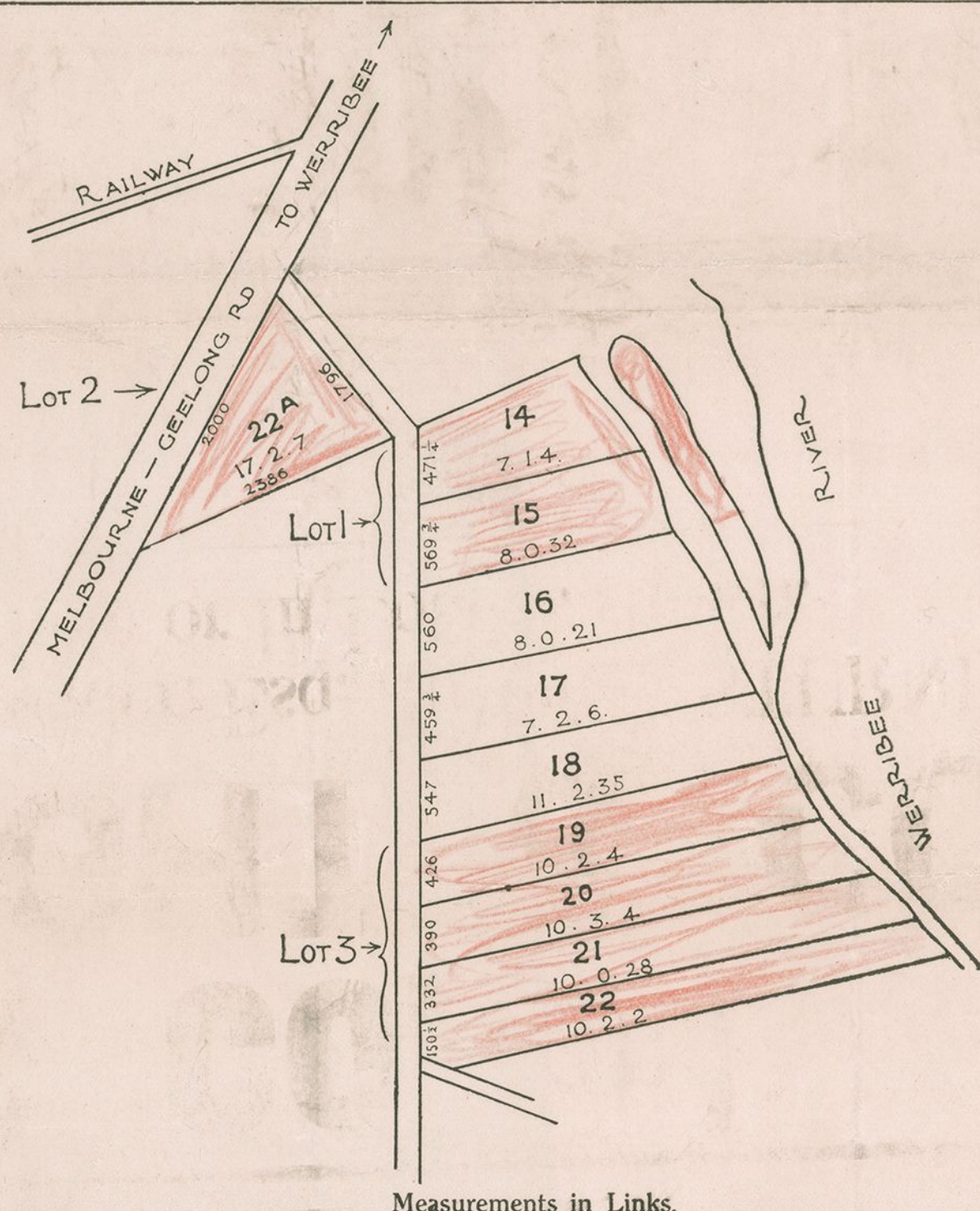

The property is subdivided into convenient paddocks, and is close to Werribee, with a good motor road right to the door.

### Lot 1. 15 Acres, Solid Brick Residence,

With slate roof, hall wood panelled, 11 rooms, including large Diningroom, Bedrooms, Billiard Room, Bathroom, Pantry, Kitchen, Washhouse, Meat House. Electric Light throughout. Garage, Stables, Loose Box. Water Laid on. Windmill and tanks. Good Frontage to Werribee River. Rich flats, Orchard and Splendid Garden.

### Lot 2. 17 acres on Main Melbourne Road and Farm Road

Seven acres in Lucerne, 10 acres under wheat, well fenced and watered, 5-roomed W.B. Cottage, a good Compact Farm

### Lot 3. 42 Acres Rich River Flats.

A Splendid Frontage to the River, well fenced. 20 acres under oats, 20 acres of fallow. 1½ miles from Railway Station, 16 chains from Lot 1. All could be irrigated.

The only reason for Selling is that Mr. Blackler intends to live on his New South Wales Property.

SOLICITORS: Messrs. SMITH & McEACHARN, 285 COLLINS STREET, MELBOURNE.

For further particulars apply to

**T. H. LAIDLAW & CO.**, 437 Collins Street, Melbourne, and Branches,  
**THOS. ROADKNIGHT & Co.**, 6 Malop Street, Geelong, Auctioneers in conjunction.